

Pedestrian footways affected by CH8 signage will maintain a walkway of 1.2 metres minimum.
Cones will be used with any signage that is placed in the carriageway and all signs will be suitably weighted.

Shuttle lane running will be a minimum of 3.25 metres

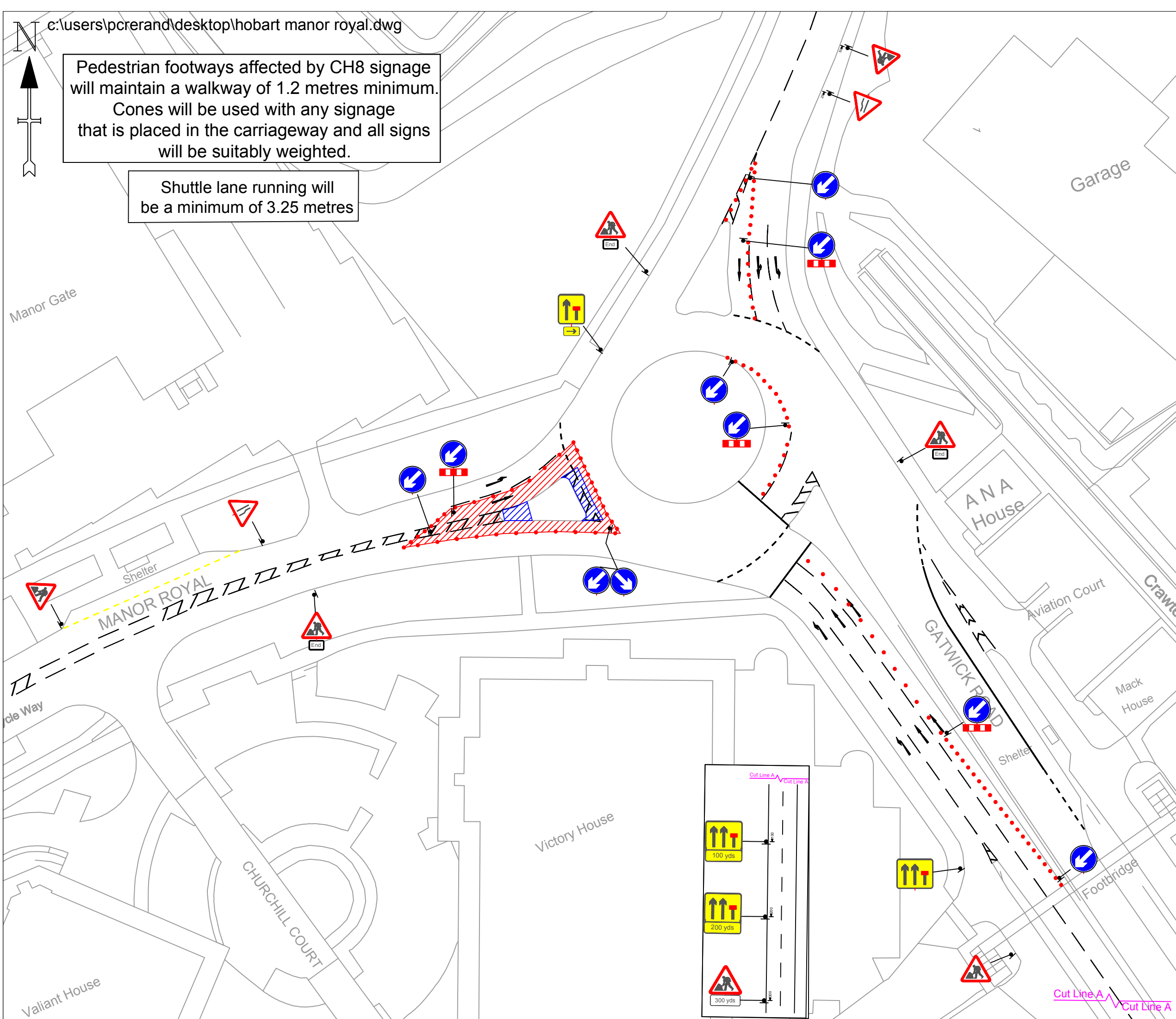

MARTIN H W Martin (Traffic Management) Ltd.
Head Office: Fordbridge Lane, Blackwell, Alfreton, Derbyshire, DE55 5JY
Telephone: 01773 813213 Fax: 01773 813331 www.hwmartin.com

Member of the **TMCA** TRAFFIC MANAGEMENT CONTRACTORS ASSOCIATION

AMBER LANGIS
UNIT 5&10 MILL PLACE, PLATT IND ESTATE, MAIDSTONE ROAD, SEVENOAKS, TN15 8FD
TEL: 01732 783980 FAX: 01732 780941 WEB: www.amberlangis.com

Additional Information:
All drawings are compliant with
Safety at Street Works and Road Works
A Code of Practice

- Drawing Keys:
KEY
- Traffic sign
 - Traffic cone
 - Traffic signals to Diagram 3000.1
 - Working Space
 - Safety Zone
 - Pedestrian Barrier

SAFETY ZONE DIMENSIONS (S)
Permanent speed limit 30mph or less
Sideways safety zone 0.5m
Longways safety zone 0.5m
(Dimensions are minima)

Client: **Hobart**
Paving & Civil Engineering

Type of works: Lane closure

Title of Scheme/Project: Manor Royal Roundabout

Name of drawing: Manor Royal Gatwick Road Crawley

Speed limit of road:

Drawing Number: AL005

Date Drawn: 05/12/18	Date Checked: 05/12/18	Date Approved: 05/12/18
Drawn by: Paul Crerand	Checked by: Jeff Cornwell	Approved by: Simon Camm

Current revision 2

See previous revisions below.

Rev	Details:	Date:
1	Tm Signage Added (Phase 6)	05/12/18
2	Tm Signage Added	28/01/19

Original Drawing size A3 Scale NTS

This drawing is the property of the H W Martin group of companies, no part of this drawing may be reproduced in any form without prior permission.